

## OPERATION AND WORKING :-

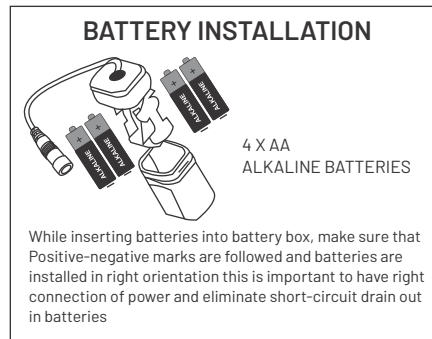

## PRECAUTION :-

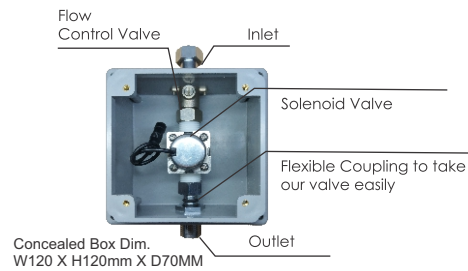
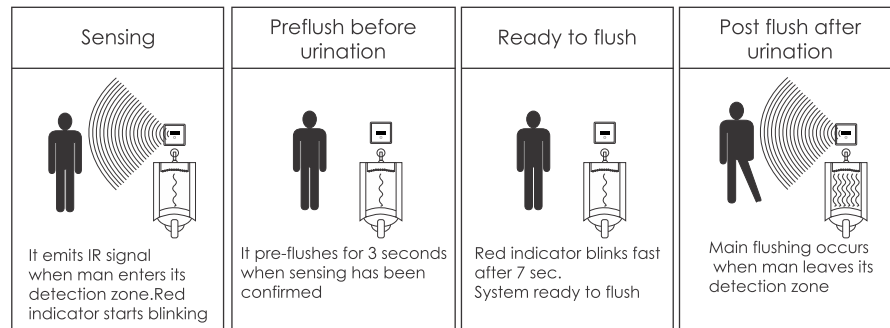

## CUSTOMER SUPPORT :-

### AFTER SALES SERVICE

Our Customer Support Team is Comprehensively trained to provide help and advice, spare parts or a service visit.

### SPARE PARTS

We maintain an extensive stock of spares and aim to have functional parts available for ten years from the date of final manufacture of the product. Spares can be purchased from approved stockists or merchants (locations on request) or direct from our Customer Support Department. Spares direct will normally be dispatched within two working days.

### NOTE

In the interest of safety, spares requiring exposure to mains voltages can only be sent to qualified persons.

### SERVICE

Our Customer Support Team is available to provide quality service at a reasonable cost.

We will be happy to assist you as our customers are our family.

**A PRODUCT PROUDLY DESIGNED & MANUFACTURED IN INDIA**

## RECESSED AUTOMATIC SMART URINAL FLUSHER

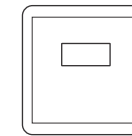

W128 X H128mm



## INSTALLATION & OPERATION MANUAL

1. Designed and manufactured in India to automatically flush urinal pot after every use.
2. An essential & dependable component in every washroom to maintain proper hygiene.
3. Simultaneously instrumental to help reduce water wastage.
4. Intelligent flushing ensures your washroom remains stink free.
5. Recovers its cost by saving significant amount of water as compared to washroom with continuously running flushing.
6. Tried and tested easily serviceable & lifetime repairable product, very adaptive to robust Indian conditions.
7. Essential for green buildings and must for every public washroom.
8. Reduces carbon footprint & saves considerable amount of operational costs as compared to conventional flushing techniques.

## SPECIFICATIONS :-

MODEL	AUTOMATIC URINAL SENSOR
POWER	AC 220V 50Hz / DC 6V - 4XAA Alkaline Batteries
SENSING RANGE	Upto 500mm Adjustable
WATER PRESSURE	0.02 Mpa - 0.8 Mpa
FLUSH TIME	7-8 Seconds Postflush
INLET/ OUTLET	G1/2" (Dn15)

## Installation Procedure

- STEP1** Cut the concealed box size groove inside wall and install plumbing and electrical lines
- STEP2** Clean the pipeline by running 1-2 bucket water until dust particles like cement pieces or thread etc. are washed away.
- STEP3** Grout concealed box with inbuilt valve inside the wall with bottom at approximately 4.5 feet height from the floor
- STEP4** Now install the water pipeline to each urinal pot through the inlet and outlet of Concealed box and open the gate valve
- STEP5** Screw the protective cover plate on the box until the site is prepared for final connections so that concealed box is protected from dust.
- STEP6** Do tiling till the level of concealed box top border

**After the wall is finished with tiles, perform the following steps :**

- STEP7** Unscrew the false plate from the concealed box
- STEP8** Install 4 X AA size alkaline batteries in battery box and place it inside the concealed box
- STEP9** For DC only installation, connect solenoid valve and battery directly to the sensor. For AC/DC installation, connect AC/DC adaptor to sensor and battery and the other terminal From sensor to be connected to solenoid valve. Connect the input of AC/DC adaptor to 220 V AC wires coming from the electrical conduit with the help of electrical tape. After connections are Done, place the adaptor inside the concealed box
- STEP10** Now take out front magnetic S.S. sheet of the sensor plate through the vacuum sucker to reach the four corner screws behind it. Screw the sensor properly to the wall concealed box and place back the magnetic sheet on the front.
- STEP11** Wait 20 Sec after connecting power for auto range setting. Do not do sensing in first 20 Sec of connecting new power source.

**Notice : Installation location:**

- No light shall enter or be reflected into the sensing window .
- No reflective objects in front of sensing window (e.g., mirror, polished stainless steel and some other polished plate).
- No strong ultraviolet radiation or electromagnetic field nearby.

**SMART SENSORS FEATURES**

1. Settings through remote
2. Can give live user count on remote
3. Can give live battery voltage on remote

### IN-BOX CONTENTS



Sensor Plate



ABS Wall Mounted Box With Inbuilt Solenoid Valve



Battery Pack



AC/DC Adpter



Protective Cover With Installation Kit



Remote (Optional)

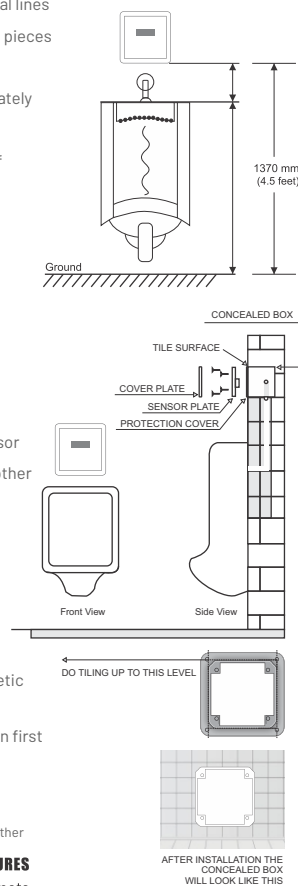

## Concealed Urinal Flusher Troubleshooting

If the following problems occur, please perform checks as follows.

SYMPTOMS	PROBABLE CAUSES	CORRECTIVE ACTION
No sensing (Indicator not flashing).	<ol style="list-style-type: none"> <li>1. No power or battery/AC connection not proper.</li> <li>2. There is a mirror or some other reflective objects within the sensing distance.</li> <li>3. The sensing window needs cleaning.</li> </ol>	<ol style="list-style-type: none"> <li>1. Check the power connection. (AC plug or Batteries)</li> <li>2. Remove the reflective Object.</li> <li>3. Clean the window.</li> </ol>
No flushing or poor flushing after person leaves (But indicator was flashing while sensing)	<p><i>System will not flush if person leaves before 7 Sec of sensing</i></p> <ol style="list-style-type: none"> <li>1. Angle Valve not fully open.</li> <li>2. Low water pressure.</li> <li>3. Filter is obstructed.</li> <li>4. Connector are not connected well.</li> </ol>	<ol style="list-style-type: none"> <li>1. Check Angle Valve</li> <li>2. Improve water supply pressure.</li> <li>3. Clean the filter.</li> <li>4. Check the connectors.</li> </ol>
Battery indicating light flashes 3 times and no flushing.	Battery voltage down.	Replace batteries.
Reduced sensing distance.	<ol style="list-style-type: none"> <li>1. Dark/non reflective clothes.</li> <li>2. Sensing range needs to be altered</li> </ol>	<ol style="list-style-type: none"> <li>1. While wearing dark clothes, one needs to stand closer to sensor as sensing range is reduced.</li> <li>2. Sensing range can be reset in first 20 sec of installing power source. Just place object at desired range with in first 20 sec</li> </ol>

## Important Consumer Information

### Consumer Responsibilities

1. Do not hit with heavy object on sensor.
2. Do not throw or spray water on sensor. The sensor is an electronic instrument.
3. Do not let sunlight or other light source enter or be reflected into sensor window.
4. Do not hang or install any reflective items such as mirror or sensor products like toilet sensor on the opposite wall.
5. Do not allow any kind of strong ultraviolet or electromagnetic field near sensor window.
6. Always use Alkaline Batteries only
7. Urinal is designed for use with potable water. Avoid water that includes a lot of contaminants or acid/ alkali or impurities.
8. When AC power unit is connected to 220V AC power supply, corresponding protective measure like circuit breakers should be used.
9. Connection with AC wire must not be inside the sensor box. It should be outside box and covered by PVC pipes.
10. Do not connect power unit to AC power supply until the sensor installation is finished.
11. AC power supply and water supply should be shut off before starting maintenance/servicing of urinal sensor.
12. All electrical connection must be compliant with related regulation and codes.
13. All installation staff should be well familiar with installation instructions.
14. Always take out atleast one bucket of water when first time water supply is started - before connecting line to concealed box inlet, so that dust particles in pipelines gets washed away without clogging solenoid valve.