

## Troubleshooting.

FAULT	CAUSE	ACTION
No water but indicator light on control box working	- Water supply cut off - Dirt in the filter - Water pressure too low	- Check water supply - Check filter (located in water inlet fitting) - Raise pressure
Water will not turn off	- Sensor window dirty	- Clean sensor window
Too little water flow	- Water supply restricted - Dirt in the filter - Water pressure too low	- Check water supply - Check filter - Raise pressure
Too much water flow	- Water supply turned on too high - Water pressure too high	- Adjust supply - Adjust pressure
Indicator light not working while sensing	- PCB or wiring loom wet - Battery loose or AC power not available	- Check Battery/ AC Plug If not resolved, Contact manufacturer

### SENSOR RANGE RESET INSTRUCTIONS:

1.Default Setting: All sensors are preset to an optimum range.

2.Reset Procedure:

- Disconnect the sensor from the power source (electricity or battery) for 15 seconds.
- Reconnect the sensor to the power source. The valve will automatically perform one operation to reset.
- You now have 20 seconds to set a new range within the maximum possible range.
- After 13-15 seconds, an operation will occur as an acknowledgment of the new sensing range setting.

## Installation Instructions

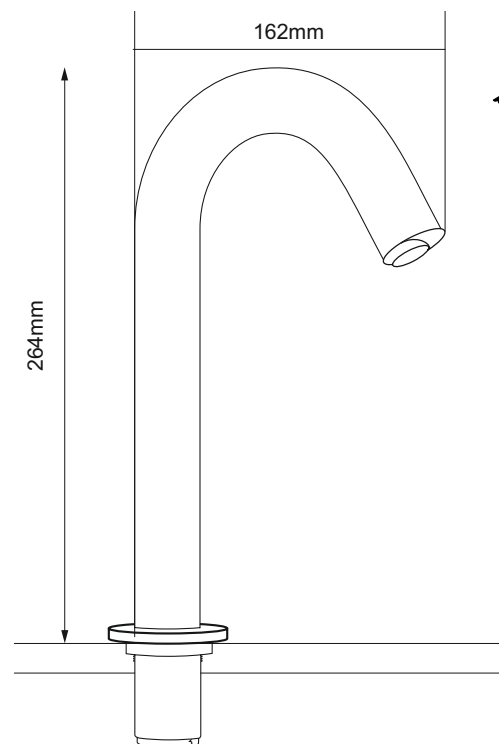

**Bharat Photon**<sup>®</sup>  
bringing India to the world...

Revolutionary  
Mouth Sensor  
Operated  
Basin Mounted  
Faucet

### Specifications :-

MODEL	BP-F292
POWER	6V DC
SENSING RANGE	80mm Adjustable
WATER PRESSURE	0.02 MPa - 0.8 Mpa *0.05 Mpa is minimum required pressure for decent flow of water
INLET	G1/2" (Dn15)
SETTINGS	Sensing range adjustment pot given at control unit ● By default range is preset at optimum value ● Alter setting only if necessary

BPE Innovations Pvt. Ltd.

Address: 3/1/25, Site-IV, Sahibabad Industrial Area,  
Ghaziabad (UP)-201010

Proudly Designed and manufactured  
in India.

BPE Innovations Pvt. Ltd. has a policy of continual improvement, all details are subject to change without notice.  
All goods are sold subject to our published terms and conditions.

TollFree : 1800 121 6254

www.bharatphoton.com

## Installations Diagram

### Determine Component Location

Determine the location of each of the components, taking into account the tube lengths and space available. The installation location should be away from sources of bright light and sunshine.

### Plan Dispense Position

Determine the position of faucet mounting hole in sink top or benchtop. Hole size required is 25mm.

### Advantage

Hidden sensor at faucet mouth eliminates sensor locating & tampering issues and gives smooth operation for great user experience.

### Turn Off Your Water Supply

Locate your mains water valve and switch it off. Then, run all of the hot and cold taps to drain any water still in the system. This will ensure you don't experience any big spills during installation.

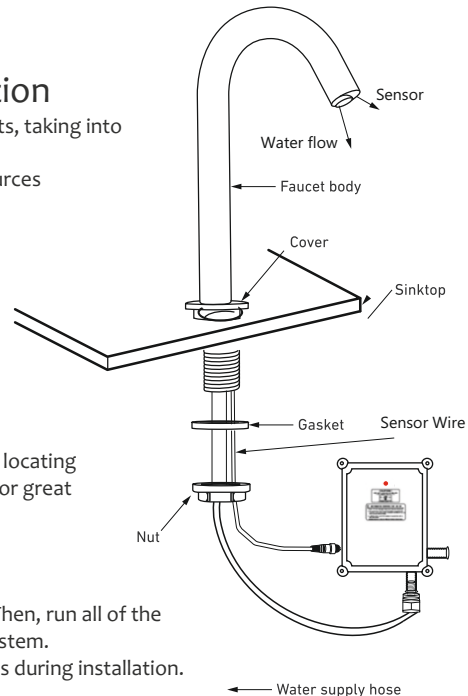

## Connection Diagram of Control Unit :-

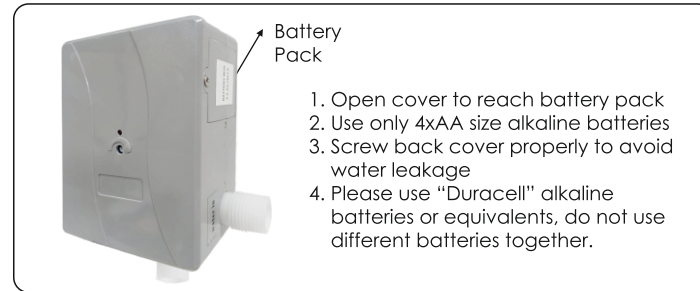

### Light Notification

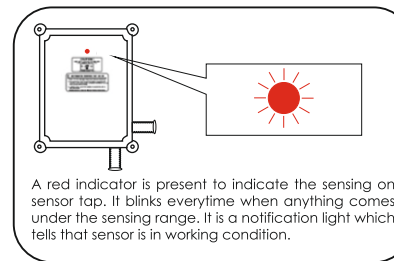

### How to clean the strainer

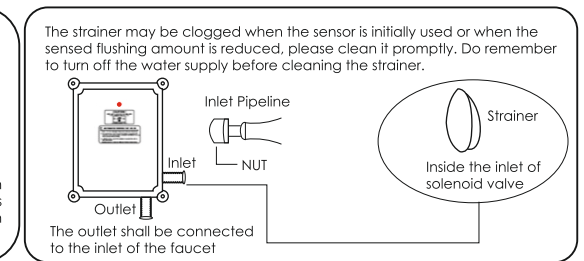

### Install Your Sensor Tap

Pass your new sensor tap, its inlet pipe and sensor cable through the mounting hole on your basin, then get down underneath it again. Tighten the faucet body with check nut provided. Attach the water inlet pipe to the corresponding inlet point on your tap's controller box. Install adaptor with washer (as shown in img) at the outlet of control box and then install pipe from faucet with washer through it.

### Mount Control Box

Control box must be fitted in right orientation as per the photo. Attach control box to wall using 4 supplied wall plugs and screws.

Note : Warranty void if control box fitted upside down or sideways.

### Wire the Sensor -

Next, attach the sensor cable from your tap to the controller box. Once done, open the top cover on your controller and load it with the appropriate batteries. In this instance, this tap requires 4 x AA batteries.

## Routine Care and Maintenance

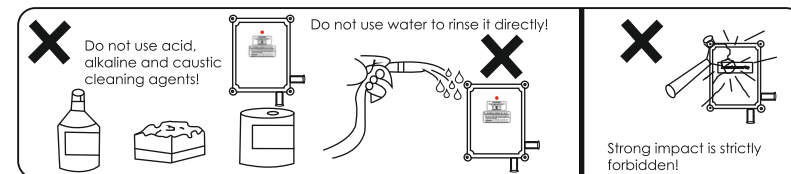

## CUSTOMER SUPPORT :-

### AFTER-SALES SERVICE

Our Customer Support Team is comprehensively trained to provide help and advice, spare parts or a service visit.

### SPARE PARTS

We maintain an extensive stock of spares and aim to have functional parts available for ten years from the date of final manufacture of the product. Spares can be purchased from approved stockists or merchants (locations on request) or direct from our Customer Support Department. Spares direct will normally be dispatched within two working days.

### NOTE

In the interest of safety, spares requiring exposure to mains voltages can only be sent to qualified persons.

### SERVICE

Our Customer Support Team is available to provide quality service at a reasonable cost. You will be assured of the services of a trained engineer / agent, genuine spares and a 3-month warranty on the repair.

**A PRODUCT PROUDLY DESIGNED & MANUFACTURED IN INDIA**