

## Connection Diagram of Control Unit :-

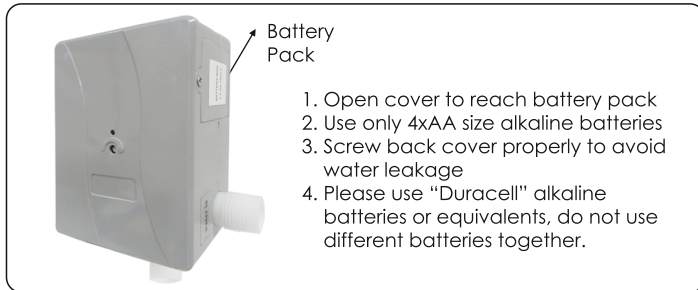

1. Open cover to reach battery pack
2. Use only 4xAA size alkaline batteries
3. Screw back cover properly to avoid water leakage
4. Please use "Duracell" alkaline batteries or equivalents, do not use different batteries together.



## AUTOMATIC SENSOR FAUCET



### LIGHT NOTIFICATION

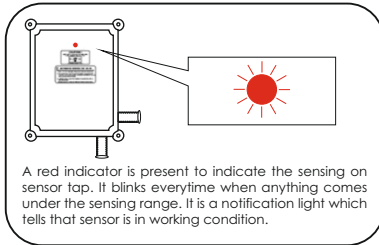

### HOW TO CLEAN THE STRAINER

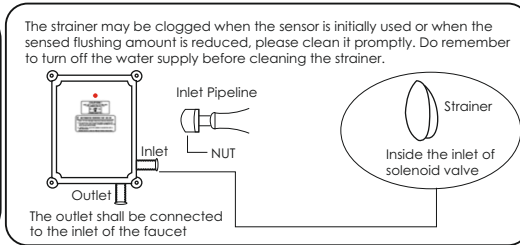

## INSTALLATION & OPERATION MANUAL

1. Designed and manufactured in India to automatically wash hands without the need to touch the tap.
2. An essential & dependable component in every washroom to maintain proper hygiene.
3. Simultaneously instrumental to help reduce water wastage.
4. Prevents the spread of germs due to physical contact of tap.
5. Ensures no one leaves the tap running after use as water flows only for the duration when hand is in front of the sensor.
6. A tried and tested easily serviceable & lifetime repairable robust Indian answer to use & throw 'locally branded imported models' marketed widely in India.
7. A true Indian product that confirms to Green Building Standards.
8. Reduces carbon footprint & saves considerable amount of operational costs as compared to manual taps.

### ROUTINE CARE AND MAINTENANCE

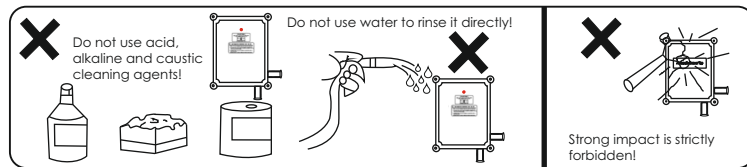

### CUSTOMER SUPPORT :-

#### AFTER-SALES SERVICE

Our Customer Support Team is comprehensively trained to provide help and advice, spare parts or a service visit.

#### SPARE PARTS

We maintain an extensive stock of spares and aim to have functional parts available for ten years from the date of final manufacture of the product. Spares can be purchased from approved stockists or merchants (locations on request) or direct from our Customer Support Department. Spares direct will normally be dispatched within two working days.

#### NOTE

In the interest of safety, spares requiring exposure to mains voltages can only be sent to qualified persons.

#### SERVICE

Our Customer Support Team is available to provide quality service at a reasonable cost. You will be assured of the services of a trained engineer I agent, genuine spares and a 3-month warranty on the repair.

### SPECIFICATIONS :-

MODEL	BP-F122
POWER	6V DC
SENSING RANGE	150mm Adjustable
WATER PRESSURE	0.02 MPa - 0.8 Mpa *0.05 Mpa is minimum required pressure for decent flow of water
INLET	G1/2" (Dn15)
SETTINGS	Sensing range adjustment pot given at control unit ▶ By default range is preset at optimum value ▶ Alter setting only if necessary

**A PRODUCT PROUDLY DESIGNED & MANUFACTURED IN INDIA**

## INSTALLATION DIAGRAM :-

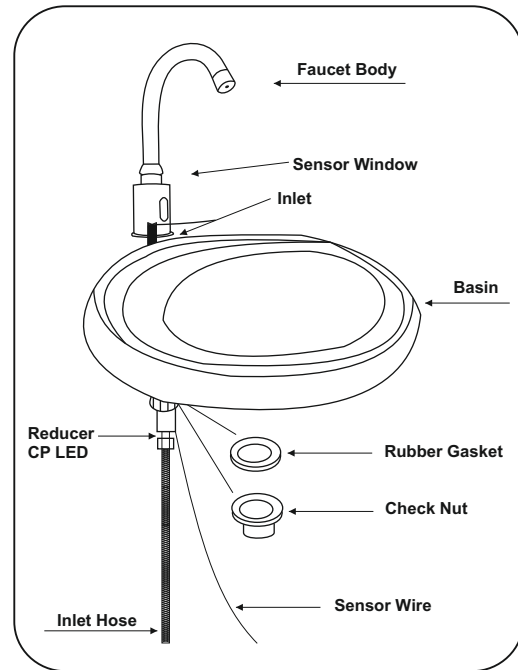
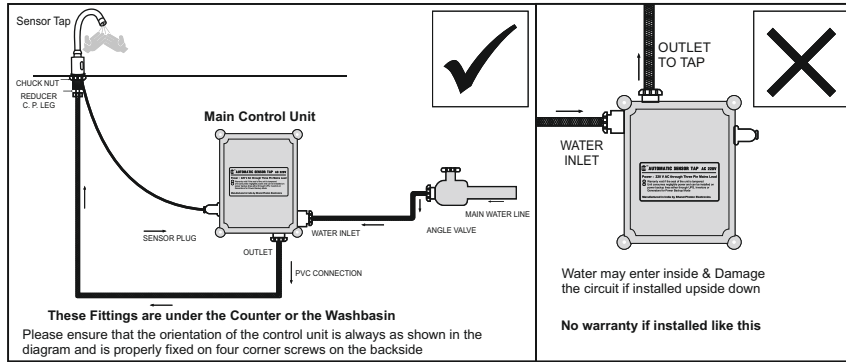

## IN-BOX CONTENTS

- ▶ Sensor faucet
- ▶ Control unit

## INSTALLATION KIT

- ▶ Screws & plastic bush
- ▶ Control box outlet adapter for faucet hose
- ▶ Rubber washer

## Automatic Sensor Faucet Troubleshoot Flowchart

